

LAYER	L
1	387
2	483
3	579

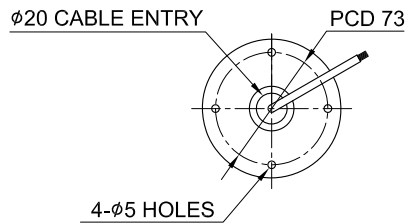

MARK	DATE	REVISION	REVISER	APP.BY
△1				
△2				
△3				

MODEL NO	SJLP				
MATERIAL	HOUSING-ABS				
	LENS-AS				
	REFLECTOR-HEAT RESISTING ABS				
COLOR OF LENS	RED(), AMBER(), GREEN()				
FLASHING PER MIN.	60 ~ 80				
USE VOLT.	LED	CURRENT	DC12V	MAX. 0.182A	LAYER1
			DC24V	MAX. 0.163A	LAYER1
			AC110V	MAX. 0.062A	LAYER1
			AC220V	MAX. 0.031A	LAYER1
			0.08W		
VOLUME	MAX. 90dB at 1m				
PROTECTION GRADE	WATER & DUST PROOF IP44				
CABLE ENTRY	φ20 LEAD HOLE				
COLOR OF HOUSING	MAKER STANDARD				
ACTION	LED STEADY/FLASHING SIGNAL TOWERS				

ISO2768-1 : CLASS OF TOLERANCE						SURFACE FINISH				1			
FOR LINEAR DIMENSIONS	f	m	⊙	v			Nr.	DWG. NO.	TITLE/ NAME	MAT'L	QTY	REFERENCE	
	0.5-3			±0.2	-	DSND BY	CHKD BY	CHKD BY	APRV BY	VIEW	DATE		
	3-6	±0.05	±0.1	±0.3	±0.5	S.H.KIM	J.H.PARK		J.K.HAN	3	2016.08.30		
	6-30	±0.1	±0.2	±0.5	±1	TITLE							
	30-120	±0.15	±0.3	±0.8	±1.5	SJLP							
	120-400	±0.2	±0.5	±1.2	±2.5	OUTLINE DRAWING							
400-1000	±0.3	±0.8	±2	±4	MODEL								
FOR ANGULAR DIMENSIONS	0-10	±1°		±1°30'	±3°	SJLP							
	10-50	±0°30'		±1°	±2°	DWG. NO.							
	50-120	±0°20'		±0°30'	±1°	SJLP_OUT							
	120-400	±0°10'		±0°13'	±0°30'	SCALE	SIZE	REV	SHEET				
					N/S	A4	00	1/1					