

1

2

3

4

5

6

A

B

C

D

MARK	DATE	REVISION	REVISER	APP. BY
①				
②				
③				

MODEL NO	S80SOL
MATERIAL	HOUSING-ABS
	LENS-PC
	REFLECTOR-HEAT RESISTING ABS
COLOR OF LENS	RED( ), AMBER( )
FLASHES PER MIN.	60 ~ 80
BATTERY CAPA.	2.4V
FLASHES PER MIN.	0.7Ah
CONTINUOUS OPERATING TIME WITH NO CHARGE	30Hr
PROTECTION GRADE	WATER & DUST PROOF IP54
COLOR OF HOUSING	MAKER STANDARD
ACTION	SOLAR CELL LED FLASHING LIGHT

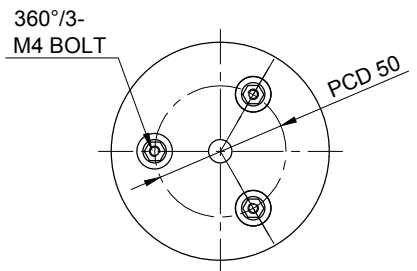
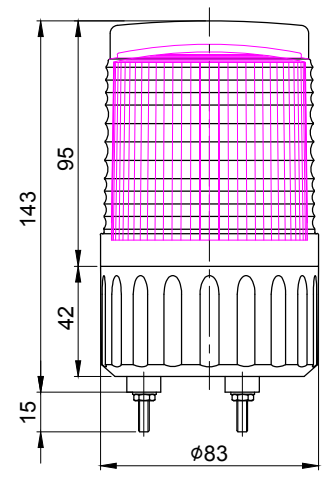

ISO2768-1 : CLASS OF TOLERANCE					
FOR LINEAR DIMENSIONS		f	m	⊙	v
	0.5~3	±0.05	±0.1	±0.2	-
	3~6			±0.3	±0.5
	6~30	±0.1	±0.2	±0.5	±1
	30~120	±0.15	±0.3	±0.8	±1.5
	120~400	±0.2	±0.5	±1.2	±2.5
400~1000	±0.3	±0.8	±2	±4	
FOR ANGULAR DIMENSIONS					
	0~10	±1°		±1°30'	±3°
	10~50	±0°30'		±1°	±2°
	50~120	±0°20'		±0°30'	±1°
120~400	±0°10'		±0°13'	±0°30'	

SURFACE FINISH		-	-	-	-	1	-
Nr.	DWG. NO.	TITLE/ NAME		MAT'L	QT'Y	REFERENCE	
DSND BY	CHKD BY	CHKD BY	APRV BY	VIEW	DATE		
Y.C.KO	J.H.PARK		J.K.HAN	3	2017.11.01		
TITLE				MODEL			
S80SOL OUTLINE DRAWING				S80SOL			
				DWG. NO.			
				S80SOL_OUT			
SCALE	SIZE	REV	SHEET				
N/S	A4	00	1/1				

1

2

3

4

5

6